



Penfold Gardens, Boughton Monchelsea, ME17 4GB
Offers In Excess Of £400,000



SUPERB FOUR BEDROOM FAMILY HOME IN EXCELLENT ORDER WITH OPEN PLAN KITCHEN/DINER IN A SOUGHT AFTER RESIDENTIAL DEVELOPMENT

This most attractive style of four bedroom home is situated on the south side of Maidstone in the parish of Boughton Monchelsea, located on the fringe of open countryside. Maidstone, the County Town of Kent, is some 4 miles distance offering a wide range of shopping, educational and social facilities. For the commuter, both Maidstone and nearby villages of Staplehurst, Marden and Headcorn offer frequent high speed services to London.

This beautifully updated home offers spacious and versatile living across two floors, making it perfect for modern family life.

Inside, there is a welcoming hallway leads to an impressive open-plan kitchen/diner. Featuring high-quality fittings, space for a Rangemaster cooker, and a wine cooler, this space is ideal for entertaining. A separate lounge runs the full length of the property, complete with a fitted media unit and French doors that open onto the garden. A practical utility room and a convenient ground-floor cloakroom complete the downstairs accommodation.

Upstairs, the home offers four generously sized bedrooms. The main bedroom enjoys a stunning ensuite with elegant marble tiles. The remaining bedrooms are served by a luxurious family bathroom, also finished with marble tiles, featuring a double shower, his-and-her sinks, and a charming roll-top bath.

Externally, the property benefits from a carport for parking and a beautifully maintained, enclosed rear garden.

This stunning family home is a must-see. Contact Page and Wells Loose Office today to arrange your viewing!



GROUND FLOOR

Sitting Room 19'9" x 10'11" (6.03 x 3.35)

Ground Floor Cloakroom

Kitchen Diner 25'6" x 19'9" (7.79 x 6.03)

Hallway

Utility Room 7'1" x 4'11" (2.18 x 1.51)

FIRST FLOOR

Bedroom 1 11'10" x 11'2" (3.61 x 3.41)

Bedroom 2 12'9" x 11'6" (3.89 x 3.53)

Bedroom 3 14'7" x 9'10" (4.45 x 3.00)

Bedroom 4 10'2" x 7'8" (3.12 x 2.35)

Ensuite

Family Bathroom

EXTERNALLY

Car Port 19'3" x 8'6" (5.88 x 2.61)

Garden to Rear

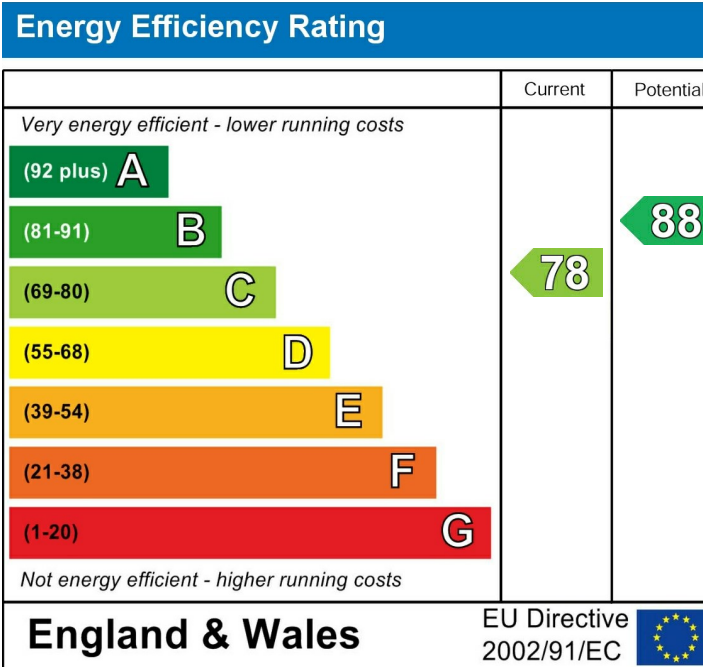

Page & Wells limited for themselves and for the vendors of this property whose agents they are give notice that: 1. These particulars do not constitute any part of, an offer or a contract. 2. All statements contained in these particulars as to this property are made without responsibility on the part of Page & Wells Limited or the Vendor. 3. None of the statements contained in these particulars as to the property is to be relied on as statements or representations of fact. 4. Any intending purchaser must satisfy himself by inspection or otherwise as to the correctness of each of the statements contained in these particulars. 5. The vendor does not make or give, and neither Page & Wells Limited nor any person in their employment has any authority to make or give any representation whatsoever in relation to this property. These particulars are supplied on the understanding that all negotiations are carried out throughout Page & Wells Limited. Properties with a reference prefixes EAA are those which Page & Wells Limited disclose an interest in accordance with the provisions of the Estates Agents Act 1979

Penfold Gardens, Boughton Monchelsea, Maidstone
Approximate Gross Internal Area
Main House = 1446 Sq Ft/134 Sq M
Carport = 174 Sq Ft/16 Sq M
Total = 1620 Sq Ft/150 Sq M

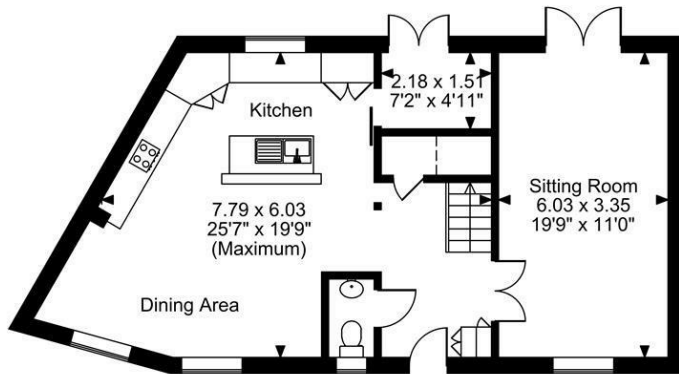
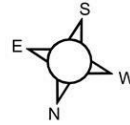

Ground Floor

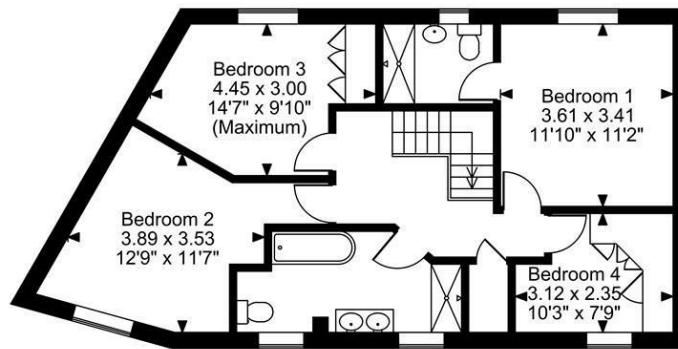

First Floor

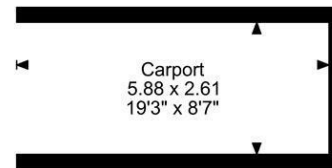

FOR ILLUSTRATIVE PURPOSES ONLY - NOT TO SCALE

The position & size of doors, windows, appliances and other features are approximate only.

□□□□ Denotes restricted head height

© ehouse. Unauthorised reproduction prohibited. Drawing ref. dig/8630018/LCO

